

**DOPPIA LAMIERA IN ALLUMINIO**  
**+ polistirene estruso**  
*double aluminium sheet  
 + extruded polystyrene  
 doppelte Aluminiumplatte  
 + extrudiertes Polystyrol*

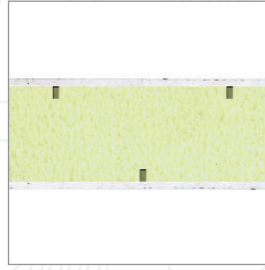

**DOPPIA LASTRA IN VETRORESINA**  
**+ polistirene estruso**  
*double fiber-glass sheet  
 + extruded polystyrene  
 Glasfaserdoppelteplatte  
 + extrudiertes Polystyrol*

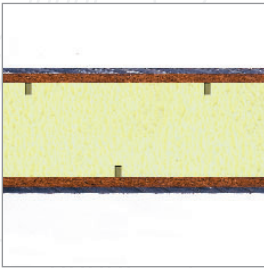

**DOPPIA LAMIERA IN ALLUMINIO**  
**con rinforzo MDF**  
**+ polistirene estruso**  
*double aluminium sheet reinforced  
 with MDF + extruded polystyrene  
 doppelte Aluminiumplatte  
 mit MDF-Verstärkung  
 + extrudiertes Polystyrol*



**DOPPIA LAMIERA IN ALLUMINIO**  
**con rinforzo MDF**  
**+ polistirene espanso**  
*double aluminium sheet reinforced  
 with MDF + expanded polystyrene  
 doppelte Aluminiumplatte  
 mit MDF-Verstärkung  
 + expandiertes Polystyrol*



**DOPPIA LASTRA IN VETRORESINA**  
**con rinforzo MDF e alluminio**  
**+ polistirene espanso**  
*double fiber-glass sheet  
 with MDF and aluminium sheet  
 + expanded polystyrene  
 Glasfaserdoppelteplatte  
 mit MDF-Verstärkung  
 + Aluminiumplatte  
 + expandiertes Polystyrol*

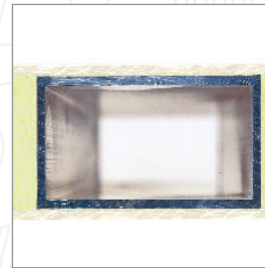

**DOPPIA LASTRA IN VETRORESINA**  
**+ polistirene estruso con tubolare**  
*double fiber-glass sheet  
 + extruded polystyrene + tubular profile  
 Glasfaserdoppelteplatte  
 + extrudiertes Polystyrol + Röhrenförmige  
 Profile*

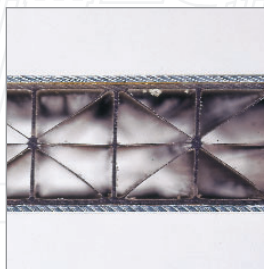

**DOPPIA LAMIERA IN ALLUMINIO**  
**+ policarbonato alveolare**  
*double aluminium sheet  
 + honeycomb polycarbonate  
 doppelte Aluminiumplatte  
 + Wabenförmiges Polykarbonat*

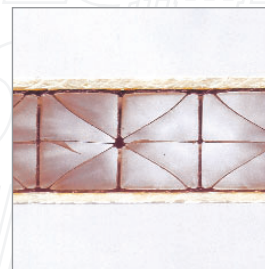

**DOPPIA LASTRA IN VETRORESINA**  
**+ policarbonato alveolare**  
*double fiber-glass sheet  
 + honeycomb polycarbonate  
 Glasfaserdoppelteplatte  
 + Wabenförmiges Polykarbonat*

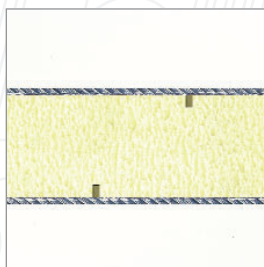

**DOPPIA LAMIERA IN ACCIAIO**  
**plastificata**  
**+ polistirene estruso**  
*double plasticised steel sheet  
 + extruded polystyrene  
 doppelte Stahlplatte mit harter  
 Kunststoffbeschichtung  
 + extrudiertes Polystyrol*

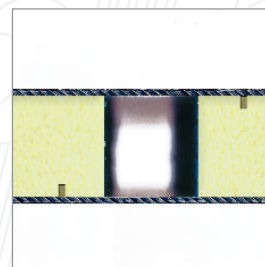

**DOPPIA LAMIERA IN ACCIAIO**  
**+ polistirene estruso**  
**con foro predisposto**  
*double steel sheet  
 + extruded polystyrene  
 doppelte Stahlplatte  
 + extrudiertes Polystyrol*