

B. Face

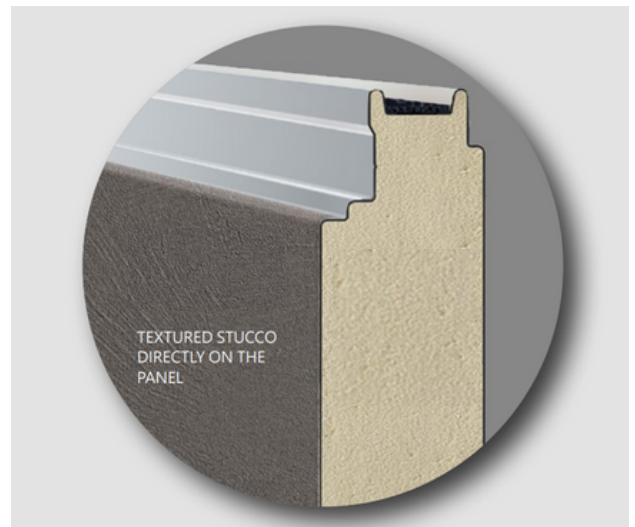

B.Face is an insulated sandwich panel with double metal cladding and a textured stucco exterior finish. B.Face has all the advantages of traditional sandwich panels for vertical cladding, combined with an innovative finish. B.Face can be made with insulation and coupling features as required and is the ideal product for use in architectural facade cladding with a unique aesthetic impact.

Sandwich panel with stucco application on the external side

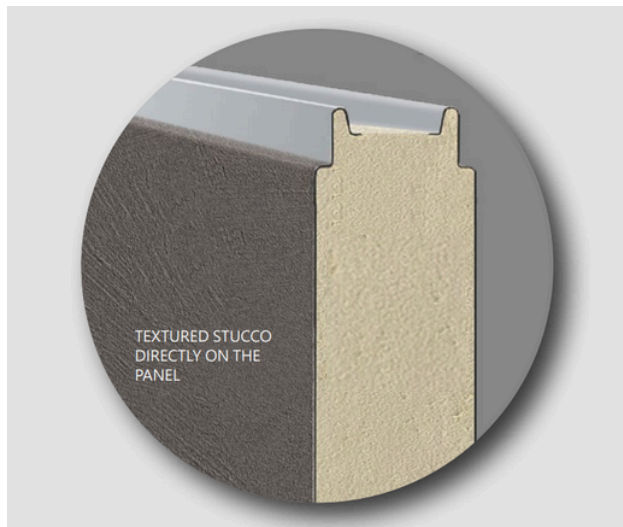

Fixing

Visible fixing

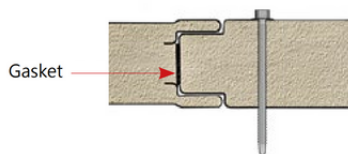

Hidden fastening

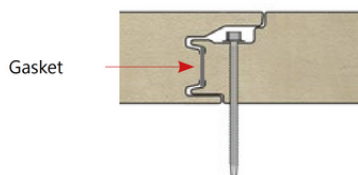

Colours



Advantages

- Weather resistant;
- UV resistant;
- Durability of mechanical and/or optical properties;
- Suitable for mechanical processing;
- Washable surface;
- Heat insulation;
- Fire resistance (with MW insulation);

REV. 01 / 2024

/// B. Face

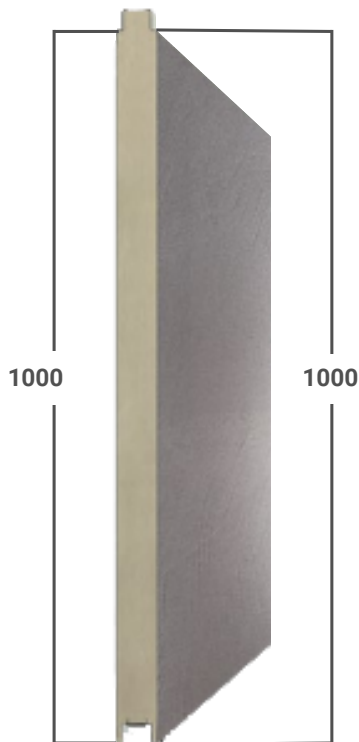

/// Technical characteristics

B.Face gives aesthetic insulation a new look.

Its unique physical properties make B.Face a technical, versatile and aesthetic product.

B.Face is resistant to all climatic and weather conditions due to its unique mechanical properties. B.Face is UV- resistant, frost-resistant and has a low thermal expansion index. B.Face is lightweight and makes the installation more efficient by reducing structural load.

/// Insulation type

- (PUR) Polyurethane insulation
- (PIR) Polyisocyanurate insulation
- (MW) Mineral fibre insulation

/// Configuration of tests performed on the stucco finish

	U.M.	VALUE SET
CONSISTENCY		Pasta
SPECIFIC WEIGHT	Kg/Lt	1,4
GRANULOMETRY	mm	0,5
THICKNESS	mm	1,2 approx.

/// Test type

	APPLICABLE STANDARDS	METHOD	U.M.	RESULT
BROOKFIELD VISCOSITY AT 20°		ASTM D 2198	CPS	135.000±20.000
RESISTANCE TO TEMPERATURE FLUCTUATIONS	UNI 9429:2015		168 h	full
UVA LIGHT RESISTANCE	UNI EN 15187:2007		400 h	full
HEAT AND HUMIDITY CYCLES IN THERMAL CYCLING CHAMBER -40°/+70° C - UR 90%	PTP 45 del 2016 Rev 1		15 cycles	no observation
CORROSION RESISTANCE – IN SALT SPRAY TEST CHAMBER	NSS UNI EN ISO 9227:2017		500h	no observation
ADHESION OF FINISH TO STUCCO SUPPORT	Uni 9240:2016		Mpa	1,6

The data reported in the tables are to be considered indicative, the designer is left to verify them according to the specific applications. Breda T.C. reserves the right to modify the data reported in the tables at any time and without notice, following the technical update of the products.

REV. 01 / 2024